

F-C-1 Concrete Ballast Flat Roof Mounting System



F-C-2 Concrete Base Flat Roof Mounting System



■ This mounting system is widely used for large-scale PV station. It takes advantage of concrete base to fix the mounting system, which is convenient and cost-effective. The main part of the system adopts Q235B steel materials with hot dip galvanized which ensures the MTBF 25 years and above. Instead of destroying the original waterproof surface, such solution could adjust the installation angle according to the specific demands.

Components list for F-C-1/F-C-2



Rail, Sloped Support, Front Support, Side Support and Back Support

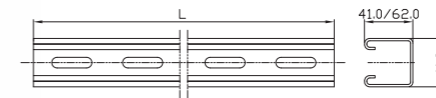

■ Material: hot dip galvanized steel Q235B



Angle Steel

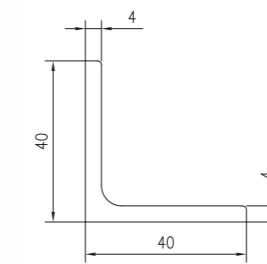

■ Material: hot dip galvanized steel Q235B
 ■ Main part of the mounting system, supporting the whole stability



373-70205-00 Front Junction A

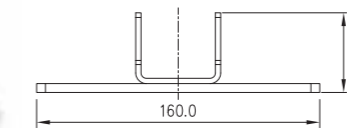

■ Material: hot dip galvanized steel Q235B



373-70129-00 Back Junction C

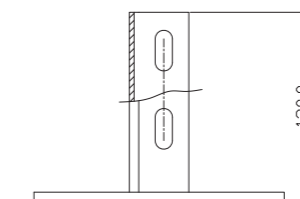

■ Material: hot dip galvanized steel Q235B
 ■ Increasing stability of the mounting system on the back



373-70125-00 Junction B

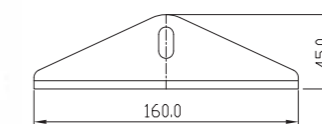

■ Material: hot dip galvanized steel Q235B
 ■ Supporting module connecting vertical and horizontal directions with adjustable angles