

## Components List for F-A

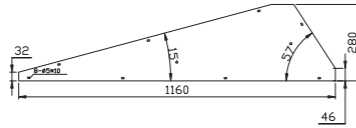

318-72160-00 Side Board



- Material : AL 6063-T6
- Resist the wind load from the side



760-30038-00 End Clamp Assembly - B02

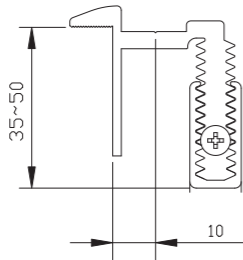

- Material :AL 6063-T6/SUS304
- Fixing modules, suitable for modules of thickness ranging from 35mm to 50mm



760-30058-00 Middle Clamp Assembly - B02

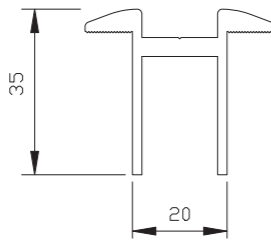

- Material : AL 6063-T6/SUS304
- Fixing modules, suitable for modules of thickness ranging from 35mm to 50mm



412-06030-00 Bolt Holder

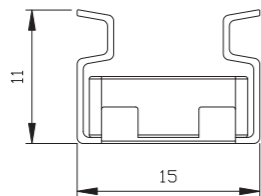

- Material : SUS304



530-08060-00 EVA Cushion

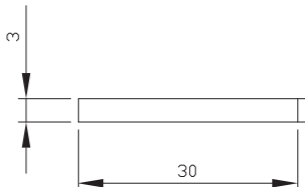

- Material : EVA
- Add friction between mounting system to roof top

## F-A series Mounting System Mechanical Parameters

### I 、 Load Parameters

The result of loading capacity according to GB 50009-2001 is as below:

Wind Load (KN/ m <sup>2</sup> )	Wind Speed (m/s)	Snow Load (KN/ m <sup>2</sup> )	Installation Angle
1.5	40	1.5	fixed/ adjustable

### II 、 Ballast List

The eddy and low pressure area effect come from wind pressure, resulting in negative pressure to modules. Therefore the whole system needs ballast to increase stability.

Wind speed (m/s)	25	30	35	40
Ballast(kg/ m <sup>2</sup> )	30	45	65	90

**Notes:** The data above is applied for Flat A mounting system , anti-slip methods is need, when installation angle is big between back board and side board.

### III 、 Tightening Torque for Screws

SUS304 or galvanized steel are raw materials of screws for connectors and clamps, etc. Dimensions are required to be calculated based on specific projects by engineers. Data of tightening torque can be referred to the table below.

Specification of Screws	M8	M10	M12	M14
Tightening Torque(Nm)	12~15	15~20	20~30	30~40